

Ideal   
Venues

# The Great Hall and Devonshire House Complex

The Great Hall, within the Devonshire House complex, is the largest of the University's facilities. Containing movable seating within the auditorium, this large space can be adapted for many different uses, from formal theatre style events, through to exhibitions, concerts and Gala Dinners.

Also situated within the Devonshire House Complex are further dining areas, attractive central bar, and meeting rooms.

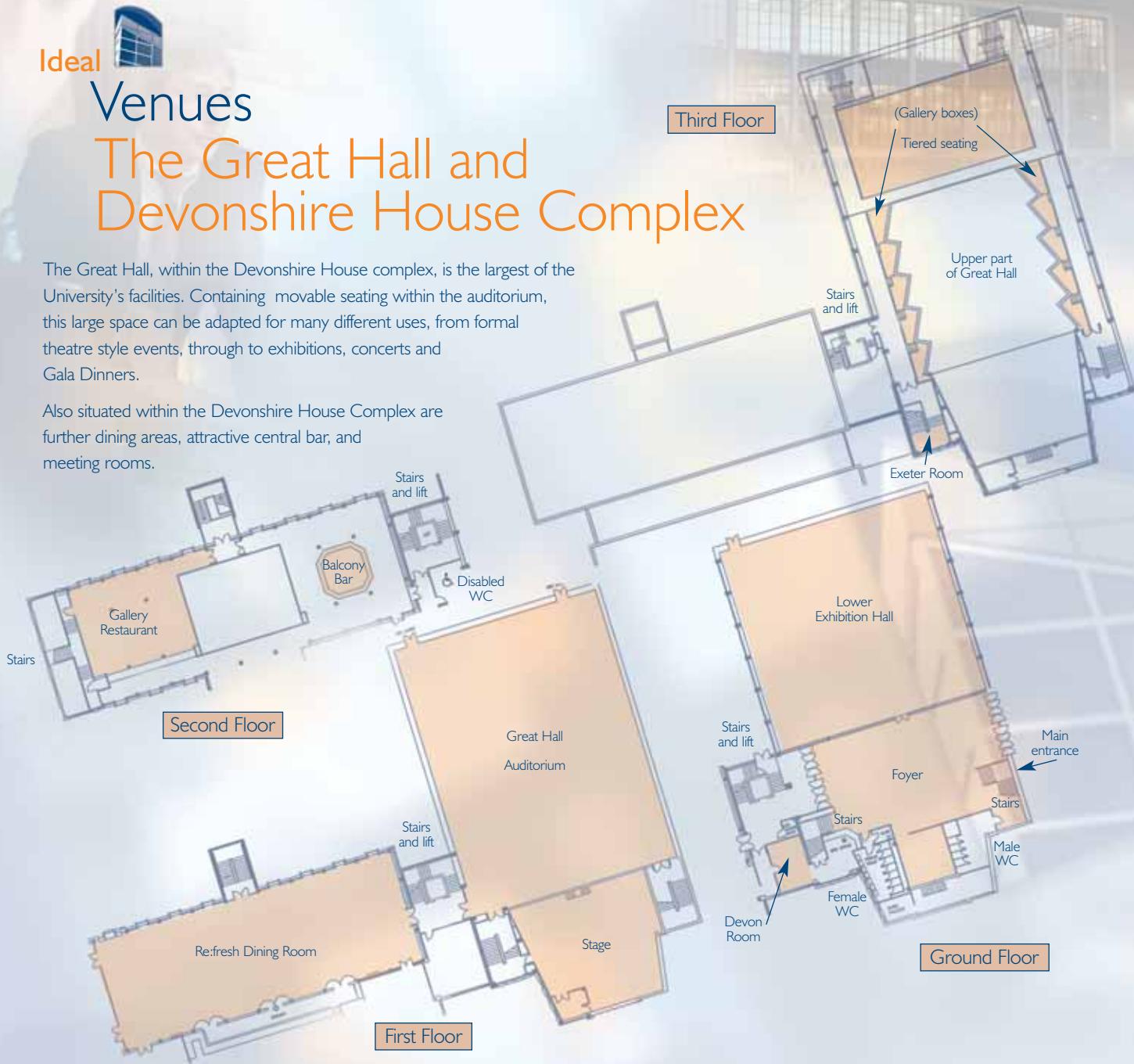

## Facilities at a Glance

	Theatre Style Max Nos	First Floor Auditorium Movable seating	Third Floor Gallery Boxes	Third Floor Gallery Fixed Tiered Seating	Board Room	Classroom Style	Seminar Room	Exhibition	Reception	Formal Dining	Finger Buffets
The Great Hall	1435	978	10 Boxes (8 seats per box)	377	-	252	-	46 stands 3m x 2m	1800	600	700
The Great Hall Stage	-	-	-	-	-	54	-	-	-	-	-
Re:refresh Dining Room	200	-	-	-	-	-	-	27 stands 3m x 2m	500	300	350
The Balcony Bar	-	-	-	-	-	-	-	-	100	-	-
The Gallery Restaurant	60	-	-	-	30	-	45	-	100	60	100
The Lower Exhibition Hall	300	-	-	-	-	174	-	33 stands 3m x 2m	400	200	200
The Devon Room	-	-	-	-	10	-	10	-	-	-	-
The Exeter Room	-	-	-	-	12	-	12	-	24	10	24

**Ideal**  
**Venues**  
**The Great Hall**  
 The First Floor

Access to the Great Hall is by lift or stairs to the first floor. The entrance is through double doors either side of the stage at the front of the hall or through doors at the rear of the auditorium, which link through to the Northcote House main reception area.

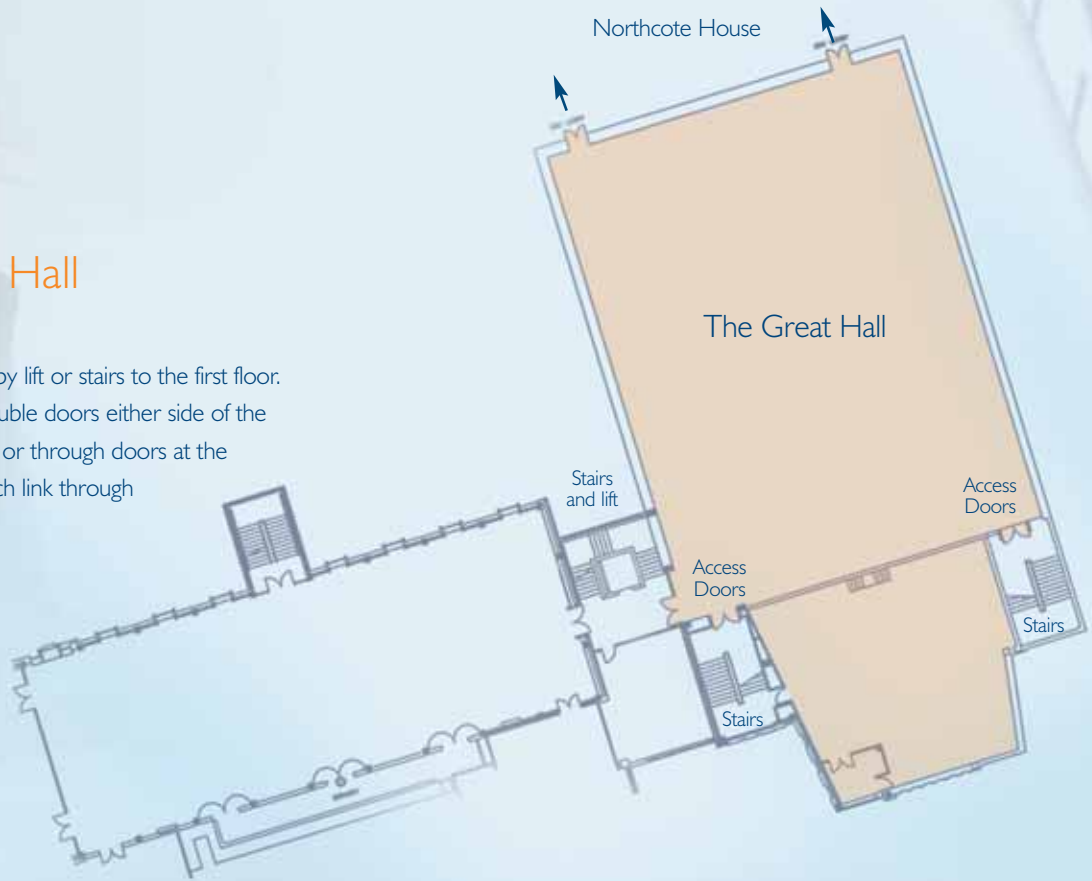

*Great Hall – formal dining*



*Great Hall stage showing different levels*

## Meeting Room Capacities

The Great Hall				
	Auditorium	Gallery	Boxes	Maximum
Theatre Style	978	377	80	1435
Classroom	252	-	-	-
Exhibition	46 stands	-	-	-

## Dining Capacities

The Great Hall		Maximum
<b>Herringbone &amp; Sprigs mix</b>		
Without Bar or Dance Floor		600
With Bar		530
With Dance Floor		540
With Bar & Dance Floor		490
<b>Banquet Style (Top table with sprigs)</b>		
Without Bar or Dance Floor		570
With Bar		500
With Dance Floor		470
With Bar & Dance Floor		450
<b>Cabaret Style (6ft round tables seating 10)</b>		
Without Bar or Dance Floor		490
With Bar		420
With Dance Floor		400
With Bar & Dance Floor		360

## Dimensions and Facilities



Great Hall – view from the stage



Great Hall – view to the stage



Great Hall – auditorium



Great Hall – auditorium

### The Great Hall

Main Floor	
Wooden floor – usable floor space	500 sq m
Length	28.31 m
Width	23.48 m
Distance between pillars at rear of auditorium	18.40 m
Distance from curtains to the stage	19.10 m
Height of floor to ceiling	12.65 m
Height of floor to front of Balcony Boxes	4.5 m
Height of floor to rear of Balcony Boxes	3.2 m
Fire Exits – 1 either side of stage 3 to the rear of the hall	Dimensions below
Access area and emergency doors	
Width of link at rear of the hall	1050 m
Depth of link at rear of the hall	3.15 m
Width of emergency doors in link	1.63 m
Height of emergency doors in link	2.04 m
Width of emergency door to the rear of hall	1.67 m
Height of emergency door to the rear of hall	2.01 m
Width of emergency door to the front of hall	
Height of emergency door to the front of hall	
Balcony Level	
Height of the front of Balcony floor to ceiling	7.62 m
Height of the rear of Balcony floor to ceiling	2.75 m
Stage	
Height from main floor to stage floor	1.52 m
Width of stage for 1st level	15.98 m
Height to ceiling from 1st level	6.4 m
Depth of stage from 1st level to 2nd level	4.88 m
Height up to 2nd level	0.35 m
Width of stage for 2nd level	13.42 m
Height to ceiling from 2nd level	6.04 m
Depth of stage from 2nd level to 3rd level	1.95 m
Height up to 3rd level	0.38 m
Width of stage for 3rd level	8.76 m
Height to ceiling from 3rd level	6.36 m
Depth of stage from 3rd level to rear of stage (3rd level of stage can be removed if required)	3.66 m
Piano lift on 1st level	3.35 m x 2 m
Distance between steps at either side of stage	9.25 m
Distance of steps from floor to stage	2.92m

### The Great Hall

Heating	Floor heating / cooling system with ceiling air extraction above. No air conditioning
Lighting	One wall of glass – good natural light with blackout blinds Auditorium – standard house lights Stage – fluorescent lights on stage Lighting is controlled by a 'Fat Frog' desk and built in house dimmer racks, which can produce lighting effects as follows: White / Colours / Colours with sequences/Foot lights / Spot lights / Flood lights.
Built in equipment	• Conference PA System • Portable PA System • CD player • Tape cassette deck • Bose Foldback • Microphones various, including radio and lapel microphones • Mirror Ball • Balloon Net
Telephone points	None in this area
ISDN lines	None in this area
Power supplies	200 amp 3 Ph N & E Camlocks 125 amp 3 Ph N & E "C" Form Socket 125 amp 3 Ph N & E "C" Form Socket (sound only) 63 amp 3 Ph N & E "C" Form Socket 32 amp 3 Ph N & E "C" Form Socket For health and safety reasons, and electrician will always be in attendance when any of the above are used 13 amp Ring mains on Stage • 13 amp Ring mains in Hall 13 amp Ring mains on Balcony
Parking	Great Hall car park outside main entrance with 2 accessible parking bays. Further parking on opposite side of the road
Access	Lift and stairs access to all levels. Accessible toilet on 2nd floor



**Ideal Venues**  
**Re:refresh Dining Room**  
 First Floor



### Dimensions and Facilities

Re:refresh Dining Room			
<b>Wooden floor</b> – usable floor space	305 sq m	<b>Heating</b>	Covered radiators
<b>Length</b>	32.8 m	<b>Lighting</b>	Ceiling spot lights Pendula ceiling lights Wall lights
<b>Width</b>	9.3 m	<b>Built in equipment</b>	-
<b>Height of floor to ceiling</b>	Highest point 6.2 m Lowest point 2.3 m	<b>Telephone points</b>	-
<b>Access Doors</b>	From the Great Hall	1.9 m high 1.5 m wide	<b>Power supplies</b>
	From the stairwell (2 sets of doors)	1.9 m high 0.4 m wide	19
<b>Fire Exits</b>	Via access doors as above and also on the outer wall	2.0 m high 1.5 m wide	<b>Parking</b>
			Great Hall car park outside the main entrance with 2 accessible parking bays. Further parking on opposite side of the road
		<b>Access</b>	Via lift or stairs from the ground floor

### Dining Capacities

Re:refresh Dining Room	
Banquet Style (Top table with sprigs)	Max. numbers
Without Bar or Dance Floor	300
With Bar	200
With Dance Floor	200
With Bar & Dance Floor	150
<b>Herringbone &amp; Sprigs mix</b>	
Without Bar or Dance Floor	250
With Bar	150
With Dance Floor	150
With Bar & Dance Floor	100
<b>Cabaret Style (6ft round tables seating 10)</b>	
Without Bar or Dance Floor	200
With Bar	150
With Dance Floor	150
With Bar & Dance Floor	100
<b>Informal</b> Set out café style with a mix of round/square/rectangular tables	216
<b>Finger buffet</b>	350



Refectory – Dining room

Ideal

# Venues

The Great Hall  
Foyer, Devon Room  
and Lower Exhibition Hall  
Ground Floor

The Devon Room seats up to 10 Board Room Style

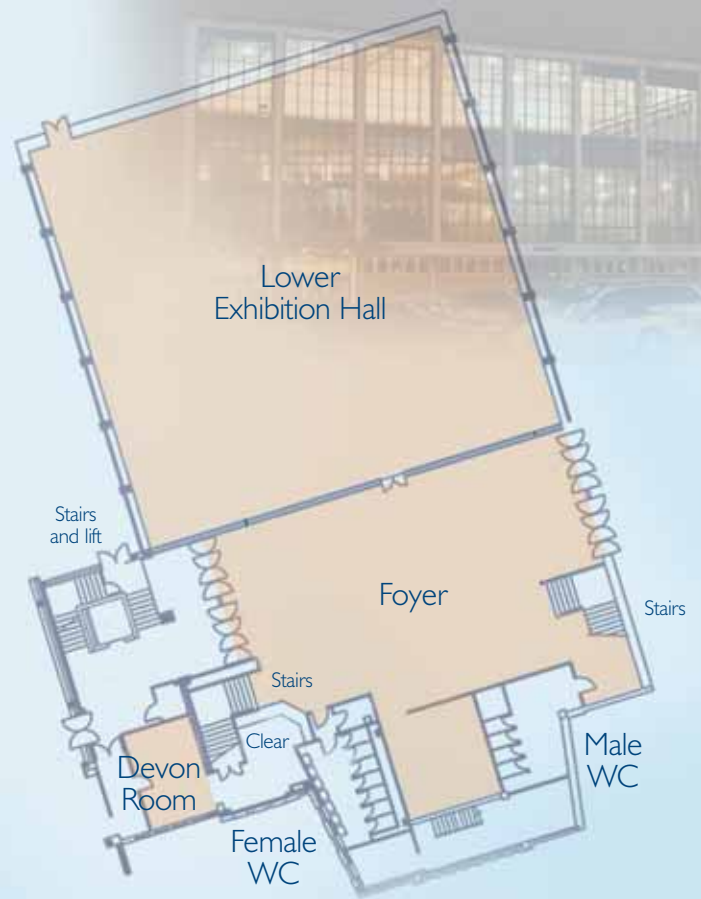

## Dimensions and Facilities

The Great Hall Foyer	
Wooden floor – usable floor space	112 sq m – tiled
Length	17.8 m
Width (from reception to Lower Exhibition Hall)	6.3 m
Height of floor to ceiling	3.2 m
Access Doors	<ul style="list-style-type: none"> <li>• 2 sets of double doors</li> <li>• 1.4 m wide x 1.9 m high</li> <li>• 4 single doors 0.67 m wide x 1.89 m high</li> </ul>
Fire Exits	Through main access doors
Heating	Wall vents
Lighting	Natural light from entrance doors. Suspended ceiling lights
Built in equipment	Reception 6.2 m wide and 3.64 m deep with cloakroom
Telephone points	-
Power supplies	4
Parking	Great Hall car park outside the main entrance with 2 accessible parking bays. Further parking on opposite side of the road
Access	Via lift or stairs from the ground floor

Lower Exhibition Hall		
Height	Floor to ceiling	3.200 m
	Floor to lights	3.048 m
	Floor to ceiling between pillars	3.048 m
	Floor to ceiling along both sides in front of windows	2.745 m
Length		21.184 m
Width		23.393 m
Doorways	Entrance from Foyer	1.450 m wide – 2 m high
	Emergency door to car park	1.600 m wide – 2.180 m high
Usable floor area		500 sq m
Access route		Main entrance from foyer Can also access by side door by car park
Pillars		5 pillars in the centre of the room
Fire Exits		Side wall out to car park
		Back wall to rear of building
Heating		Radiators
Lighting		Natural light
		Fluorescent lights above Slatted blinds at windows
Number of power points		4 x double 13amp
		– 2 on front wall / 2 on back wall
		10 x single 13amp
		2 on each side of pillar

## Meeting Room Capacities

The Lower Exhibition Hall	
Meeting Room – theatre style	300
Exhibition	33 - 3 x 2 metre stands
Exam layout	174 candidates with desks
	3 invigilating officers with desks

## Dining Capacities

The Lower Exhibition Hall	
Catering Options	Maximum numbers
Informal Dinner	200
Finger Buffet	200
Reception	400

Ideal



## Venues

### The Gallery Restaurant and Balcony Bar

Second floor

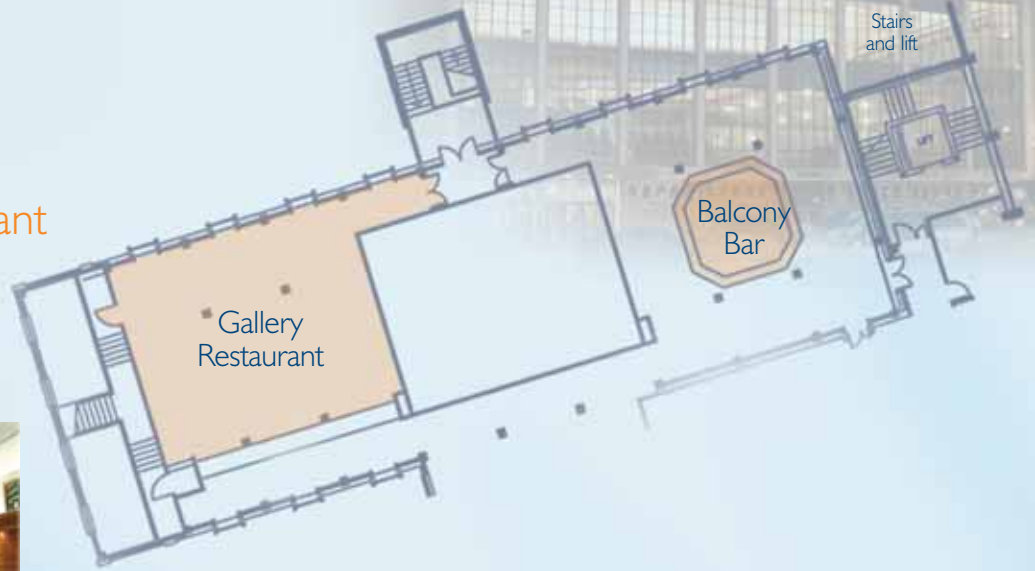

Gallery restaurant



Balcony bar



Exeter room

## Dimensions and Facilities

The Gallery Restaurant		
Wooden floor – usable floor space	90 sq m	
Length	10.2 m	
Width	8.9 m	
Height of floor to ceiling	3.0 m	
Access Doors	From the Bar	From the Stairs
Width	0.90 m	0.72 m
Height	1.92 m	1.89 m
Fire Exits (sliding doors to lounge area and garden)	Via access doors	
Heating	Covered radiators	
Lighting	Recessed ceiling lights	
Built in equipment	Servery	
Telephone points	-	
Power supplies	16	
Parking	Great Hall car park outside the main entrance with 2 accessible parking bays. Further parking on opposite side of the road	
Access	Via lift or stairs from the ground floor	

The Balcony Bar has an attractive central bar with lounge seating. This area can accommodate receptions for up to 100.

Ideal



## Venues

### The Exeter Room

Third floor

The third floor contains the Exeter Room providing a light airy meeting space and access to the Great Hall gallery and tiered seating.

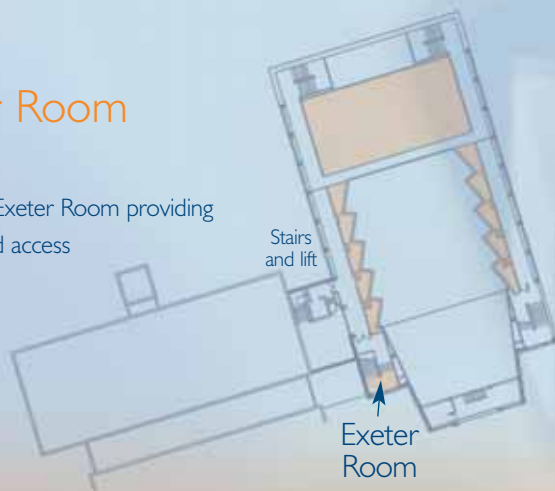

For further information please speak to one of our event team on the following number:

Telephone +44 (0)1392 215566

Fax +44 (0)1392 263512

Email [conferences@exeter.ac.uk](mailto:conferences@exeter.ac.uk)

[www.exeter.ac.uk/hospitality](http://www.exeter.ac.uk/hospitality)